

# Swanscross, Co Monaghan

This farm has drumlin soils and is located at Swanscross, Monaghan.

Teagasc Advisor: James O'Donoghue +353 (0)47 81188

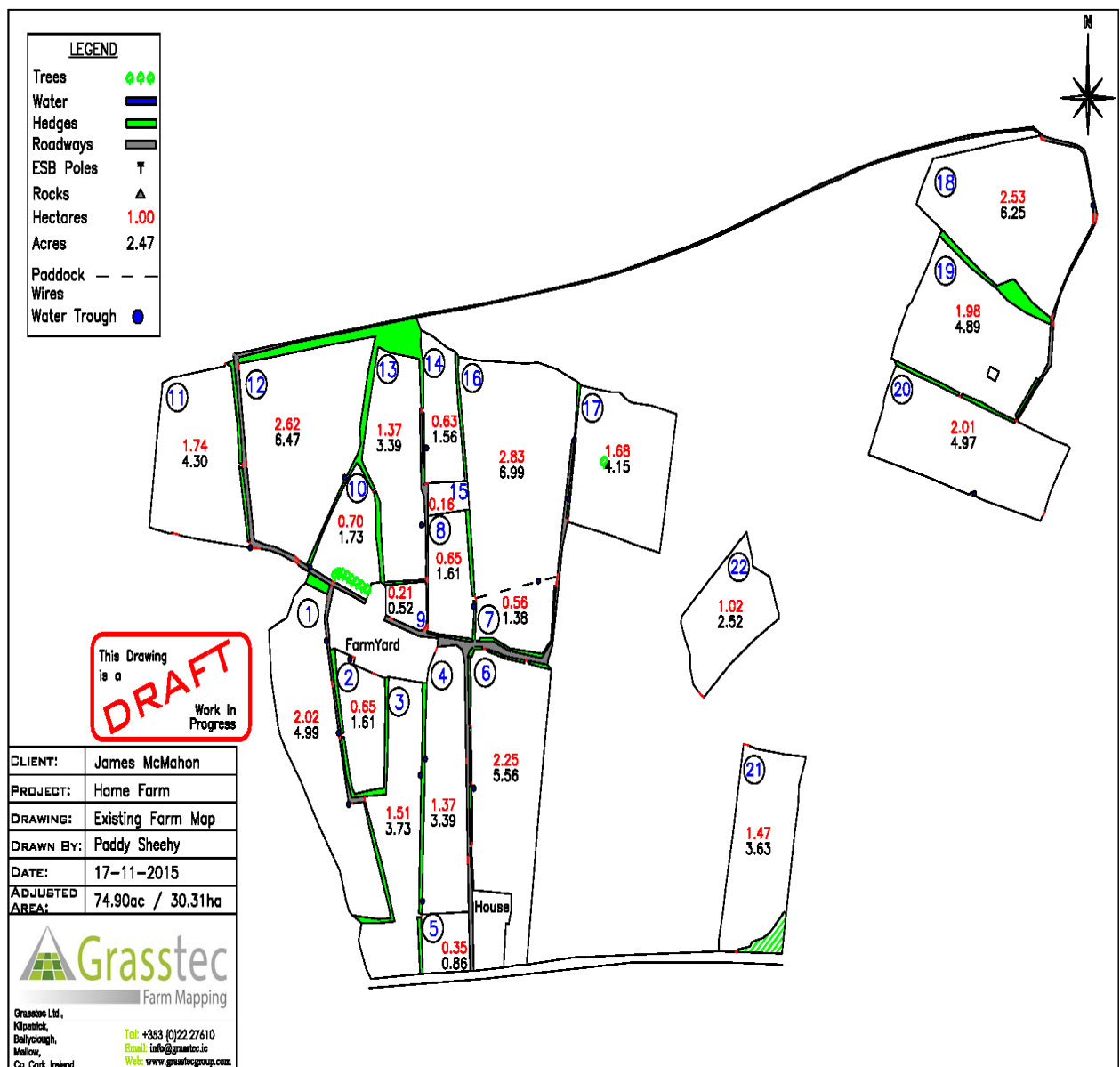

**Table 1. Farm Performance**

Year	Herd Size	Rate	Area MP	EBI	EBI	6 week
		MP	Ha	Total	Fertility	Calv %
2014	94	3.26	28.8	74	31	25
2015	92	3.29	28.8	84	36	7
2016	101	3.51	28.8	38	7	15
2017	104	3.61	28.8	44	11	11
2018	104	3.61	28.8	78	21	11
2019	110	3.82	28.8	101	36	49

**Table 2. Dairy Outputs**

Year	Milk Solids/ha	Gross Output	Gross Output	Total costs	Total Costs	Net Margin	Net Margin
	Kg	€/Ha	c/litre	€/Ha	c/litre	€/Ha	c/litre
2014	1362	4158	36	2204	21.3	1954	14.7
2015	1422	3106	27.2	2583	23.9	523	3.4
2016	1430	3007	27.3	2256	21.8	751	5.5
2017	1540	4473	36.11	2745	22.16	1728	13.95
2018	1252	4696	36.3	3401	15.13	1295	10.06
2019	1595	3886	32.16	2872	23.77	1014	8.39

**Table 3. Grass production Tonnes Dry Matter/hectare**

Grass Production	Start Grazing	End Grazing	Total Grown (Tonnes)
2016			10.5
2017	17th Feb	20th Dec	7.2
2018	25th Mar	9th Nov	11.3
2019	26th Feb	25th Nov	10

Regular grass measurement commenced in 2016.

